

RELEVU HALA - CORP VECHI
 PARTER
 SCARA 1 : 250
 PROPRIETAR : S.C. SOUTHERN PROPERTIES S.R.L.
 STR. POPA SAVU, NR.18, ET.1, CAM.102, SECT. 1
 BUCURESTI

HALA - CORP NOU

ADRESA IMOBILULUI :
 STR. GARA PROGRESULUI, NR.2, SECT.4
 BUCURESTI

Recapitulatie suprafete :

Nr. incapere	Denumire incapere	Suprafata utila mp.
7	DEPOZIT	2124.18
8	BIROU	14.74
9	BIROU	17.59
10	BIROU	6.88
11	BIROU	9.52
12	BIROU	12.20
13	BIROU	9.54
14	BIROU	12.90
15	BIROU	17.75
16	BIROU	6.97
17	BIROU	6.92
18	CASA SCARII	21.68
19	CASA LIFT	7.14
SUPRAFATA UTILA TOTALA =		2268.01 mp.

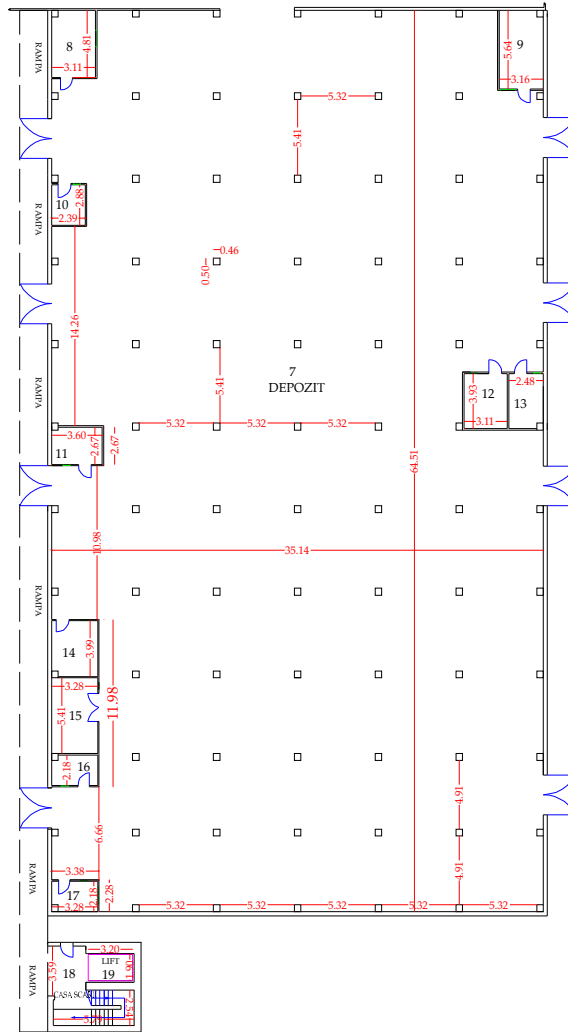

Executant :
 Lupu Daniel

Data :
 1.10.2008