

RELEVEU HALA - CORP NOU  
 ETAJ 1  
 SCARA 1 : 200  
 PROPRIETAR : S.C. SOUTHERN PROPERTIES S.R.L.  
 STR. POFA SAVU, NR.18, ET.1, CAM.102, SECT. 1  
 BUCURESTI

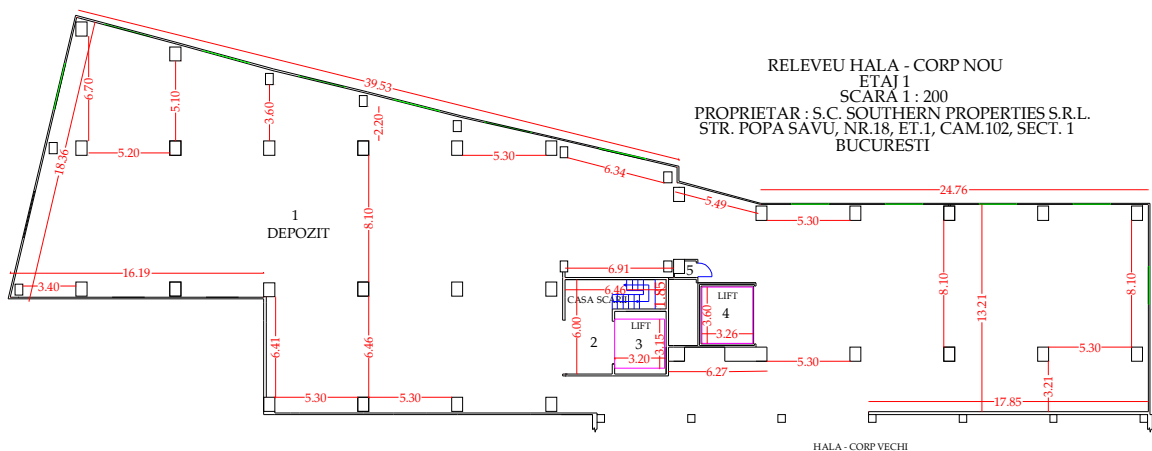

ADRESA IMOBILULUI :  
 STR. GARA PROGRESULUI, NR.2, SECT.4  
 BUCURESTI

Recapitulatie suprafete :

Nr. incapere	Denumire incapere	Suprafata utila - mp -
1	Depozit	1080.03
2	CASA LIFT	24.41
3	CASA LIFT	10.08
4	CASA LIFT	11.72
5	TABLOU ELECTRIC	0.97
SUPRAFATA UTILA TOTALA =		1127.21 mp.

Executant :  
 Lupu Daniel

Data :  
 1.10.2008